

\$52,500

0 Bedroom, 0.00 Bathroom,
Single Family on 0.00 Acres

Tofield, Tofield, AB

Huge 11,192 sq/ft, pie-shaped lot in Tofield!
Fully serviced lot with a 52ft pocket width!
Cul-de-sac location. Resential tax Incentive is
associated with this lot. Small town feel with
some big city amenities! A must See !!!



Essential Information

MLS® #	E4419154
Price	\$52,500
Bathrooms	0.00
Acres	0.00
Type	Single Family
Sub-Type	Vacant Lot/Land
Status	Active

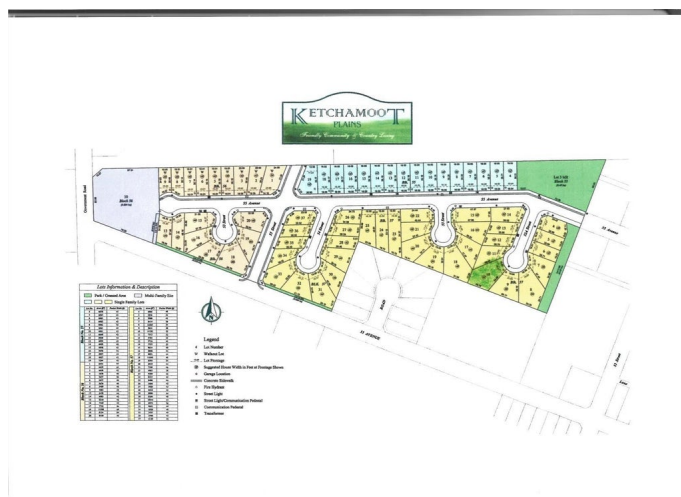

Community Information

Address	5415 52b Street
Area	Tofield
Subdivision	Tofield
City	Tofield
County	ALBERTA
Province	AB
Postal Code	T0B 4J0

Exterior

Exterior Features Cul-De-Sac, Flat Site

School Information

Elementary	C.W.Sears Tofield (K-4)
Middle	Tofield (5-9)
High	Tofield

Additional Information

Date Listed	January 24th, 2025
Days on Market	106
Zoning	Zone 80

DATA IS DEEMED RELIABLE BUT IS NOT GUARANTEED ACCURATE BY THE REALTORS® ASSOCIATION OF EDMONTON. COPYRIGHT 2025 BY THE REALTORS® ASSOCIATION OF EDMONTON. ALL RIGHTS RESERVED.Trademarks are owned or controlled by the Canadian Real Estate Association (CREA) and identify real estate professionals who are members of CREA (REALTOR®, REALTORS®) and/or the quality of services they provide (MLS®, Multiple Listing Service®)

Listing information last updated on May 10th, 2025 at 3:17pm MDT